



# C & C DOORS & FRAMES



# 18G Series Door

www.ccddoorsandframes.com

1-844-649-1843



## 18G Series Door - 18 Gauge, A40 Galvanized, Flush Door

### Design

Following ANSI/SDI A250.6, A250.8, and A250.10

- 1-3/4" Reversible Flush Door
- 18GA Galvanized Steel Skin
- 16GA Flush Top Channel
- 16GA Inverted Bottom Channel
- 12GA Door Closer Reinforcement
- 10GA Hinge Reinforcement
- Non Handed, Square Edge Design

### Certificates

- WHI 3 Hrs Fire Rated
- Positive Pressure & S Label
- STC Rated
- Thermal Rated

### Core Types

- Polystyrene
- Honeycomb

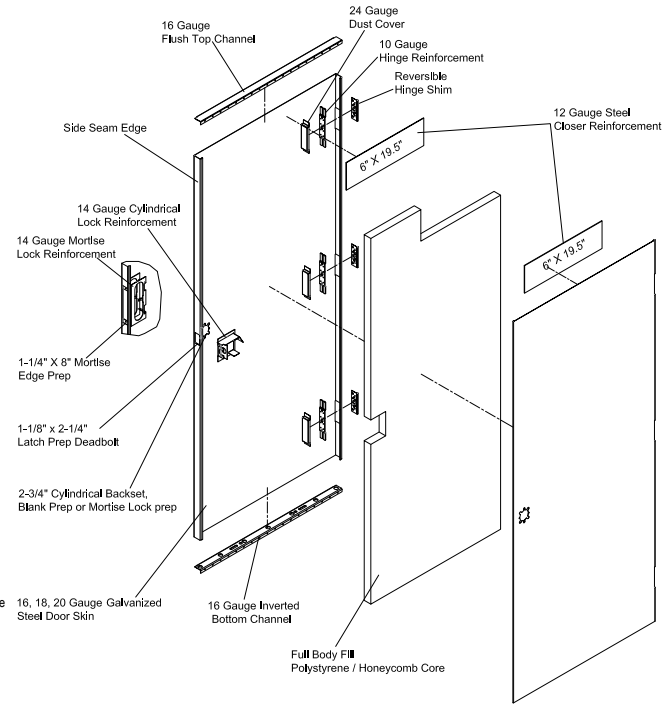
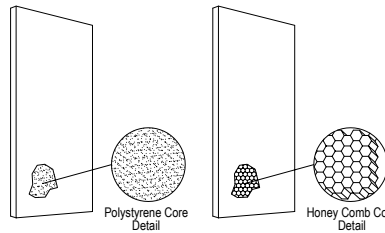

## Door Sizes per ANSI SDI A250.8

Widths*	Ft-in	2'0"	2'4"	2'6"	2'8"	2'10"	3'0"	3'4"	3'6"	3'8"	4'0"
	mm	610	711	762	813	864	914	1016	1067	1118	1219

\* Sizes shown are for single doors only; equal pairs of doors use twice the width indicated. Pairs of doors can consist of two unequal widths.

Heights	1-3/4" Doors	Ft-in	6'8"	7'0"	7'2"	8'0"
		mm	2032	2134	2184	2438

## Door Types Example – per SDI Standard

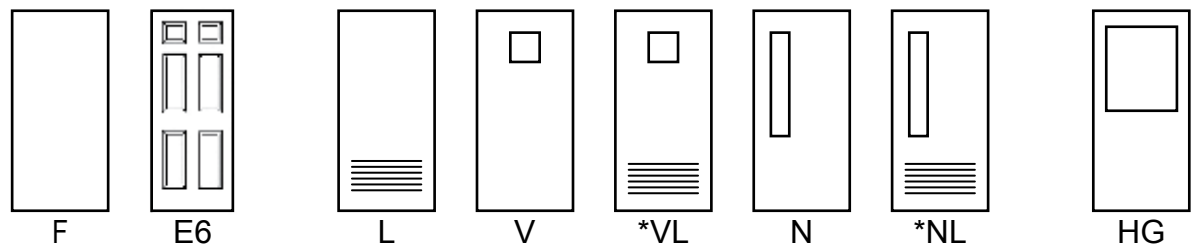

### 3hrs Label Style

F – Flush      L – Louvered (top or bottom)  
 NL – Narrow Light and Louvered      E6 – 6 Panel Embossed

### 1.5hrs Label Style

V – Vision Light      VL – Vision Light and Louvered  
 HG – Half Glass

### 45mins Label Style

N – Narrow Light

\* Doors with Windows and Louvers on the same door is non rated



# Door Reinforcement & Hardware Fitting

www.cdoorsandframes.com

1-844-649-1843



## Door Reinforcements

### Following ANSI/SDI A250.8

ANSI/SDI A250.8, the standard door and frame industry's standard specification, indicates the following hardware reinforcing gages as the industry norm. These same gages appear in the DHI's brochure "Hardware Reinforcements for Steel Doors & Frames".

HARDWARE	DOOR THICKNESS	FRAME
Hinge 1 3/4" (44mm) Door**	.123" (3mm)***	.123" (3mm)***
Mortise Lock or Deadbolt**	.067" (1.6mm)	.067" (1.6mm)
Bored Lock or Deadbolt**	.067" (1.6mm)	.067" (1.6mm)
Flush Bolt Front**	.067" (1.6mm)	.067" (1.6mm)
Surface Bolt****	.067" (1.6mm)	.067" (1.6mm)
Surface Applied Closer****	.067" (1.6mm)	.067" (1.6mm)
Hold Open Arms****	.067" (1.6mm)	.067" (1.6mm)
Pull Plates and Bars****	.053" (1.3mm)	.053" (1.3mm)
Surface Exit Device****	.067" (1.6mm)	.067" (1.6mm)
Floor Checking Hinges	.167" (4.2mm)	.167" (4.2mm)
Pivot Hinges	.167" (4.2mm)	.167" (4.2mm)
Kick Plates / Pull Plates	Not Required	Not Required

\* Minimum steel thicknesses are derived from minimum thickness for specific gauges as defined by WHI.

\*\* A thinner steel may be employed as long as tapped holes used for mounting the hardware are extruded to produce an equivalent number of threads.

\*\*\* If reinforcing is angular or channel shaped, .093" (2.4mm) is permitted.

\*\*\*\* When reinforcing is omitted and thru-bolting is required, the use of spacers or sexbolts is required.

## Door Hardware Fittings on Steel Door

### Following ANSI/BHMA A156.115 for Hardware Preparations in Steel Doors and Steel Frames

- T – 161 Turtle Prep.  
Preparation of 1-3/4" Steel Doors for Bored Locks with Lever Handles, ANSI/BHMA A156.115-A115.18.
- M – 86 Prep.  
Preparation of 1-3/4" Steel Door for Mortise Lock, edge preparation with blank door face ANSI/BHMA A156.115-A115.1.
- BR – Blank Reinforced for Exit Device.
- IA – Inactive Door with
  - a. ASA Strike Prep.
  - b. Auto/Manual Flush Bolt Prep, ANSI/BHMA A156.115-A115.4.
  - c. Z Astragal with Flush Bolt & ASA Prep.
- T48 – 161 Turtle Prep. with Dead Lock Prep. @ 48" CLAFF
- 4CDL – 4" CTC (Center to Center, ANSI/BHMA A156.115)
- 55CDL – 5-1/2" CTC (Center to Center, ANSI/BHMA A156.115)
- MBRR – Blank Reinforced for Exit Device and Mortise Lock.

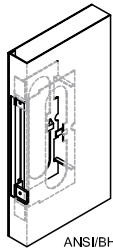
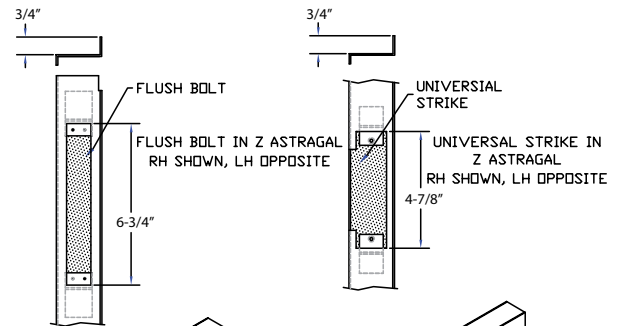

ANSI/BHMA A156.115  
"M" (MORTISE BLANK FACE)  
14GA REINFORCEMENT

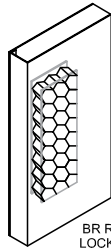

BR RIM PANIC REINFORCEMENT  
LOCK AND HINGE EDGE OF DOOR  
14GA 10" x 3 3/4" PLATES  
WITH HONEYCOMB SUPPORT

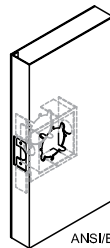

ANSI/BHMA A156.115  
"T" (CYLINDRICAL)  
14GA REINFORCEMENT

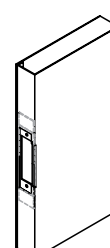

ANSI/BHMA A156.115  
"U" 4 7/8" UNIVERSAL STRIKE

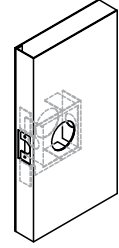

2 1/8" DEADBOLT PREP

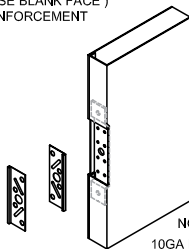

NON-HANDED HINGE  
10GA HINGE REINFORCEMENT

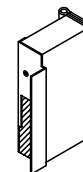

RH INACTIVE DETAIL



LH INACTIVE DETAIL



# 6G Series Frame

www.ccdoorsandframes.com

1-844-649-1843



## 6G Series 16 Gauge Galvanized KD Frames

6GM Series Masonry Frames  
6GD Series Drywall Frames

### Design

Following ANSI/SDI A250.6, A250.8, and A250.10

- Knock Down (KD) type, mitered Frame corner
- 9/32" Silencer Prep.
- Unequal rabbet with 2" face
- 4-7/8" Universal strike Prep.
- 10GA steel template hinge reinforcements
- 14GA Strike Reinforcement
- 5/8" Stop with 7/16 return on Masonry Frames, floor anchor included
- 5/8" Stop with 1/2 double return on Drywall Frames, compression and strap anchor included

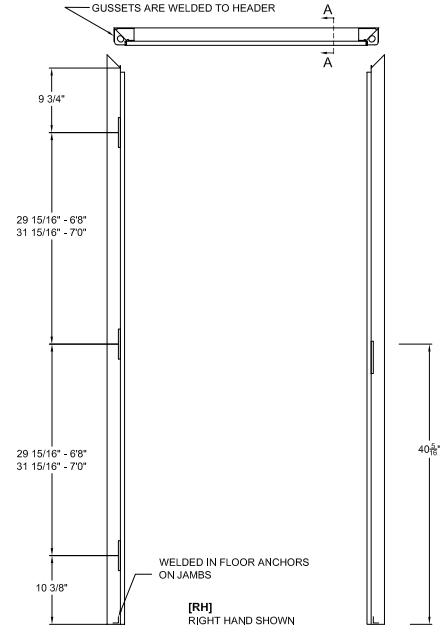
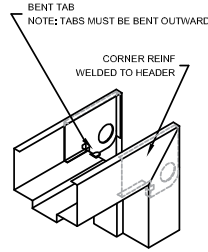

Example of 6GM

### Certificates

- 6GM Series Masonry Frame WHI 3hrs Fire rated
- 6GD Series Drywall Frames WHI 90mins Fire rated

## Frame & Jamb Profile

Standard 1-3/4" Masonry Frame - Frame with 7/16 return

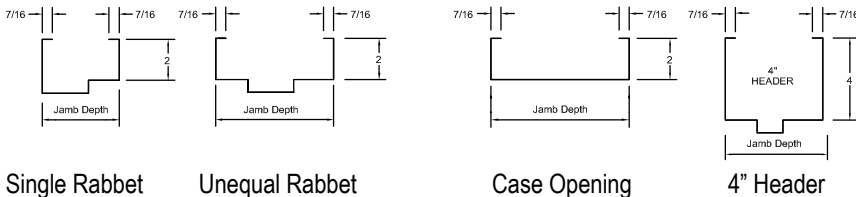

Standard 1-3/4" Drywall Frame with 1/2" double return and 5/16" back bend

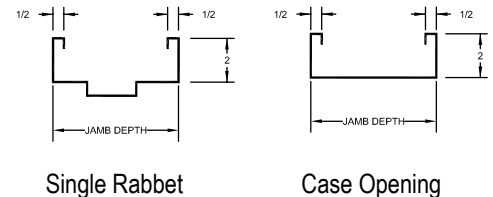

## Door Hardware Fittings on Steel Door Frame

- 4-1/2" Hinge Prep.
- 4-7/8" ASA Strike Prep.
- 2-3/4" Strike Prep. optional

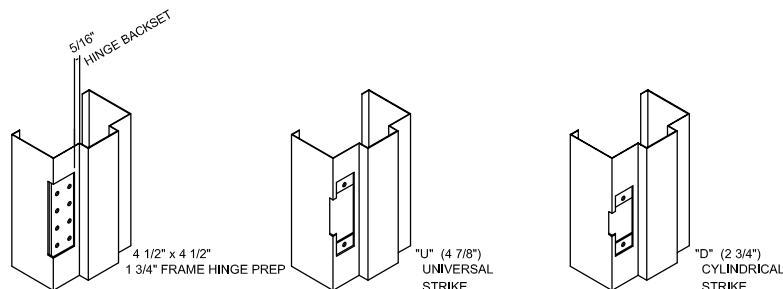

# Frame Sizes

www.cdoorsandframes.com

1-844-649-1843



## 6GM Series Masonry Frame

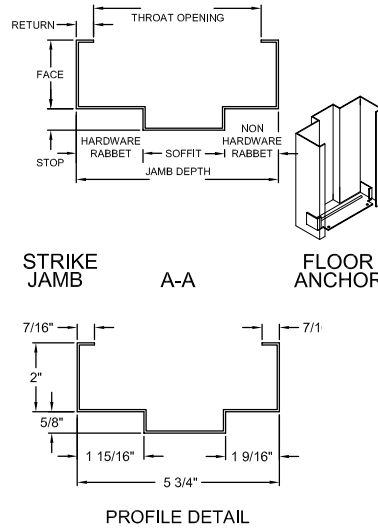
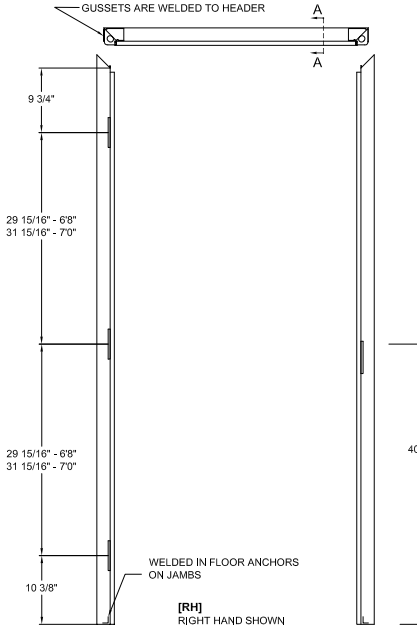

### Mounting Anchors

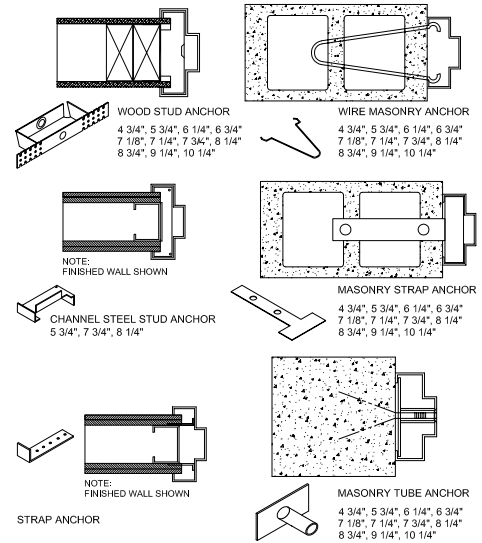

\* Other hinge location for Masonry Frame may available on request

Jamb Depth	4-3/4"	5-3/4"	6-1/4"	6-3/4"	7-1/8"	7-1/4"	7-3/4"	8-1/4"	8-3/4"	9-1/4"	10-1/4"
Throat Opening	3-7/8"	4-7/8"	5-1/4"	5-3/4"	6-1/8"	6-1/4"	6-3/4"	7-1/4"	7-3/4"	8-1/4"	9-1/4"

## 6GD Series Drywall Frame

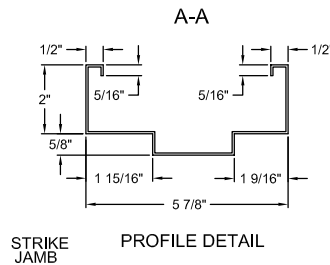
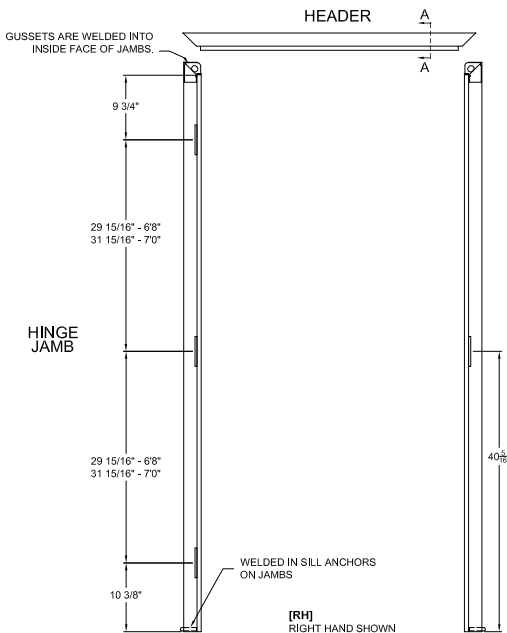

### Mounting Anchors

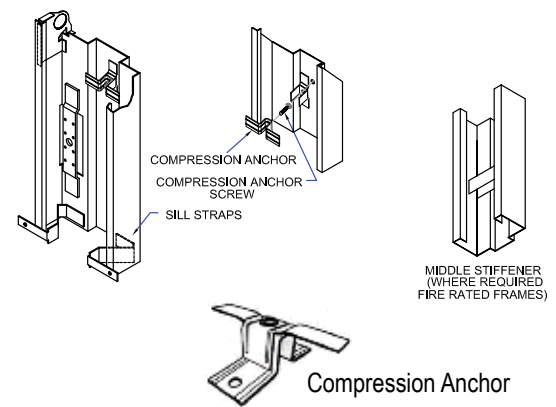

\* Other hinge location for Drywall Frame may available on request

Jamb Depth	4-3/4"	5-5/8"	5-7/8"	6-1/4"	6-5/8"	7-1/4"	7-3/4"	8-1/4"
Throat Opening	3-3/4"	4-5/8"	4-7/8"	5-1/4"	5-5/8"	6-1/4"	6-3/4"	7-1/4"



# Standard Hardware Locations



www.ccdoorsandframes.com

1-844-649-1843



## Standard Hardware Locations

3 Hinges, apply to Door height: 6'8", 7'0", 7'2"

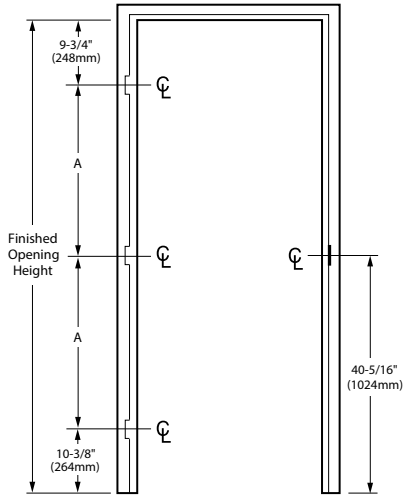

TYPICAL FRAME ELEVATION

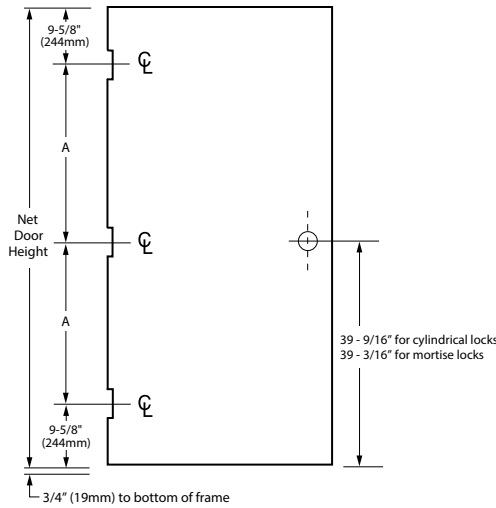

TYPICAL DOOR ELEVATION

4 hinges, apply to Door height: 8'0"

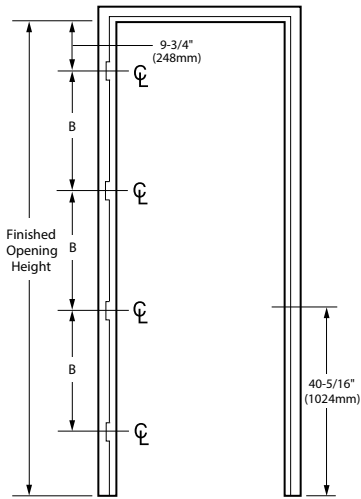

TYPICAL FRAME ELEVATION

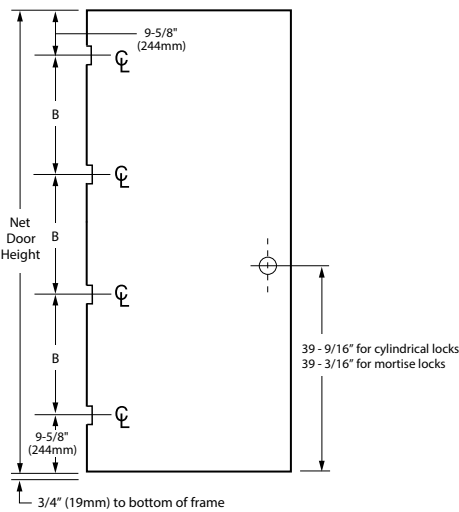

TYPICAL DOOR ELEVATION

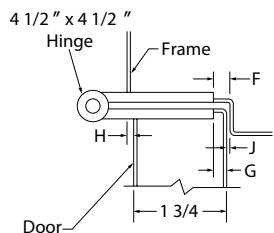

Door Opening Height	A	B	F	G	H	J
6'8" (2032mm)	29-15/16" (760mm)	25-5/16" (643mm)	5/16"	3/16"	1/16"	1/8"
7'0" (2134mm)	31-15/16" (811mm)					
7'2" (2184mm)	32-15/16" (837mm)					
8'0" (2438mm)	25-19/64" (643mm)					



# Fire Door Requirement and Door Handing

www.ccdorsandframes.com

1-844-649-1843



## Fire Door Requirements

Opening	Wall Rating	Door and Frame Rating	Description and Use
	4 Hour	3 Hour (180 minutes)	These openings are in walls that separate buildings or divide a single building into designated fire areas.
	2 Hour	1-1/2 Hour (90 minute)	Openings of this type are used in enclosures of vertical communication or egress through buildings. Examples of these types of openings include stairwells and elevator shafts.
	1 Hour	1 Hour (60 minute)	These door and frame assemblies divide occupancies in a building.
	1 Hour	3/4 Hour (45 minute)	For use where there are openings in corridors or room partitions.
	2 Hour	1-1/2 Hour (90 minute)	This opening is in a wall where there is the potential for severe fire exposure from the exterior of the building.
	1 Hour	3/4 Hour (45 minute)	This opening is in an exterior wall that has the potential to be exposed to moderate to light fire from the exterior of the building.
	1 Hour	1/3 Hour (20 minute)	These openings are in corridors where smoke and draft control is required. The minimum wall rating is 1/2 hour.

## Door Handing

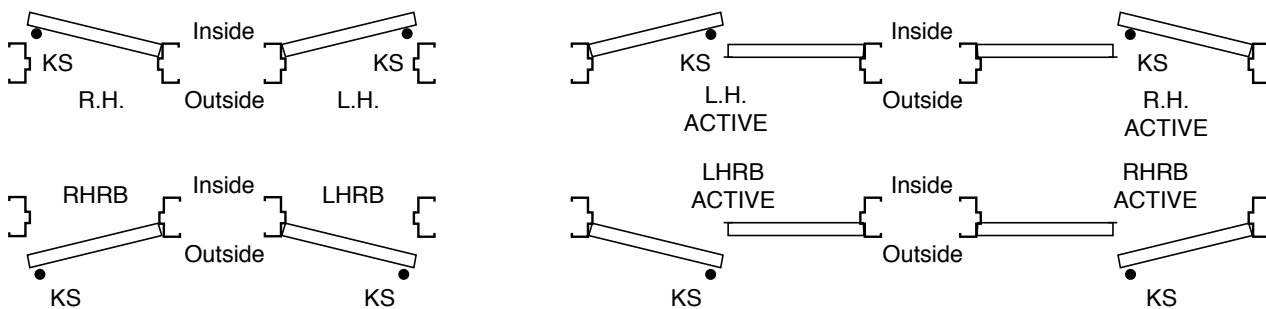

KS indicates keyed side of lockset.





Intertek

DISTRIBUTION BY:



## C & C DOORS & FRAMES, INC.

### TEXAS HEADQUARTER

(Home Office)  
4653 Leston Street, Suite 703  
Dallas, TX 75247  
Tel : (214) 774-9715  
Fax: (214) 774-9664  
Toll Free Tel: 1-844-649-1843  
[www.ccddoorsandframes.com](http://www.ccddoorsandframes.com)

### ILLINOIS DISTRIBUTION CENTER

3687 Darlene Court  
Aurora, IL 60504

### CALIFORNIA DISTRIBUTION CENTER

6590 Top Gun Street  
San Diego, CA 92121

### GEORGIA DISTRIBUTION CENTER

2319 Defoor Hills Road N.W.  
Atlanta, GA 30318

### OHIO DISTRIBUTION CENTER

5232 Tod Ave. SW, Bldg 1N8  
Warren, OH 44481